



# BOLT ON ARMRESTS ASSEMBLY INSTRUCTIONS

Ref# 2007-608, revised 11-14-07 by MCW

READ ALL INSTRUCTIONS THOROUGHLY  
BEFORE YOU BEGIN.

## CHECK ALL PARTS

- Be certain there are no missing parts.
- Be certain all required tools are available.

## REQUIRED TOOLS

- 1/4-inch Allen Wrench
- Towels (or something soft) to rest components on during assembly to protect the finish

## ASSISTANCE REQUIRED

- 1 person recommended to attach product.
- Necessary to handle, fit, and secure components.

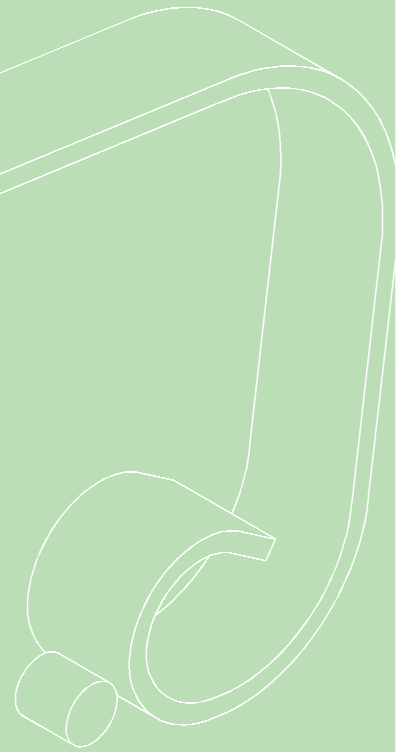

All specifications are subject to change. Contact manufacturer for details.  
Directions apply for all steel slat benches and seats that are ordered with armrests.  
Call for pricing and availability.  
It is not recommended to install armrests until bench or seat is fully assembled

## DELIVERY, STORAGE, and HANDLING

- Delivery: Deliver products to site in manufacturer's original, unopened containers and packaging. Upon delivery, examine packages immediately to ensure all products are complete and undamaged.
- Storage: Store products in a protected, dry area in manufacturer's unopened containers and packaging
- Handling: Protect product's finish from damage during handling and installation.

## PROTECTION

- Protect products prior to installation by having them remain in the manufacturer's packaging and container.



Should you have any problems, please contact Victor Stanley, Inc.

[www.victorstanley.com](http://www.victorstanley.com)



## PARTS LIST

**A** HEX DRIVE CAP BOLT  
 2 PER ARMREST

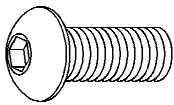

**C** 1-inch WASHER  
 2 PER ARMREST

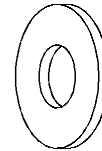

**B** LOCK WASHER  
 2 PER ARMREST

**F** ARMREST  
 AS MANY AS SPECIFIED  
 EACH ARMREST IS DESIGNED  
 TO MATCH THE PROFILE OF  
 THE BENCH OR SEAT, SEE  
 SPECIFICATIONS FOR  
 MORE DETAILS.

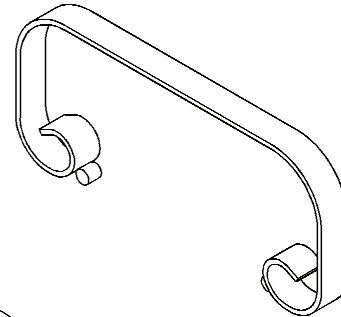
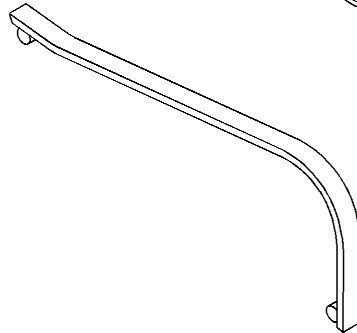
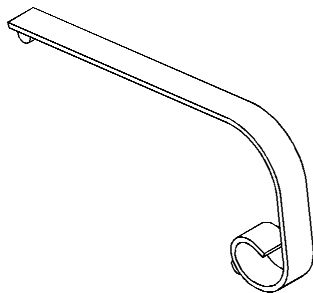

## TOOLS REQUIRED (NOT PROVIDED)

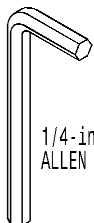

1/4-inch  
 ALLEN WRENCH



\*This symbolizes  
 when to use TOOL  
 to tighten.

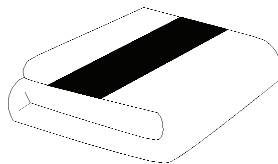

TOWELS  
 (or something soft  
 to protect finish)



HANDS

\*This symbolizes when to  
 use HAND to tighten.



**ATTENTION:** ALL IMAGES ARE OF AN NRB-6 WITH 3 ARMRESTS  
 THE STEPS REMAIN THE SAME FOR ALL BOLT ON ARMRESTS

**STEP #1** Remove all parts from their boxes and bags, and place on towels or a soft surface to prevent scratching (towels, cardboard, grass, ect.)

**STEP #2** Locate the position of the holes where the armrest will be placed. Depending on the Bench or Seat, and the number of armrests ordered, the armrests will either be attached to a slat or to a welded on support between the slats.

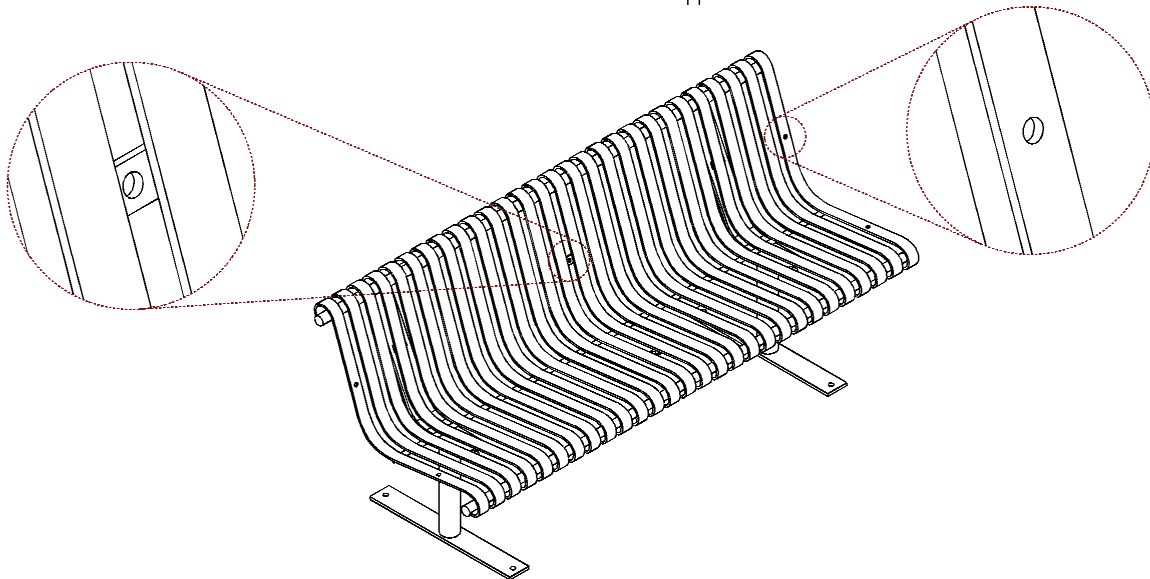

**STEP #3** Place one armrest in place, align the holes in the bench with the threaded holes on the armrest. Fasten the arm to the bench. If more then one armrest is ordered, repeat for remaining armrests.

For step #3  
 use Bolt  
 Assembly  
 as shown:

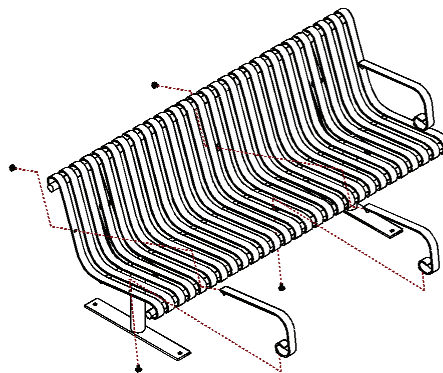
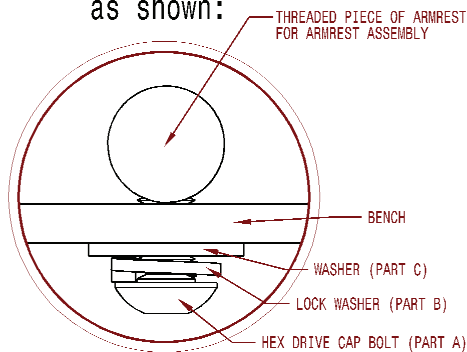

**HAND TIGHTEN**



**STEP #4**

Carefully tighten the armrests one at a time. If two people are present, tighten the bolts simultaneously. If only one person is present, tighten each bolt one turn at a time. This will prevent the armrest from being misaligned or not fastened completely. Continue this for the remaining armrests.

**NRB-6 STEELSITES™ SERIES  
 EXAMPLE FINAL PRODUCT**

**NRB-6  
 SURFACE MOUNT WITH  
 (3) BOLT ON ARMRESTS**



**TOOL TIGHTEN**

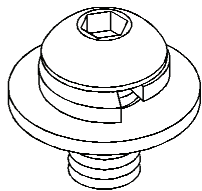
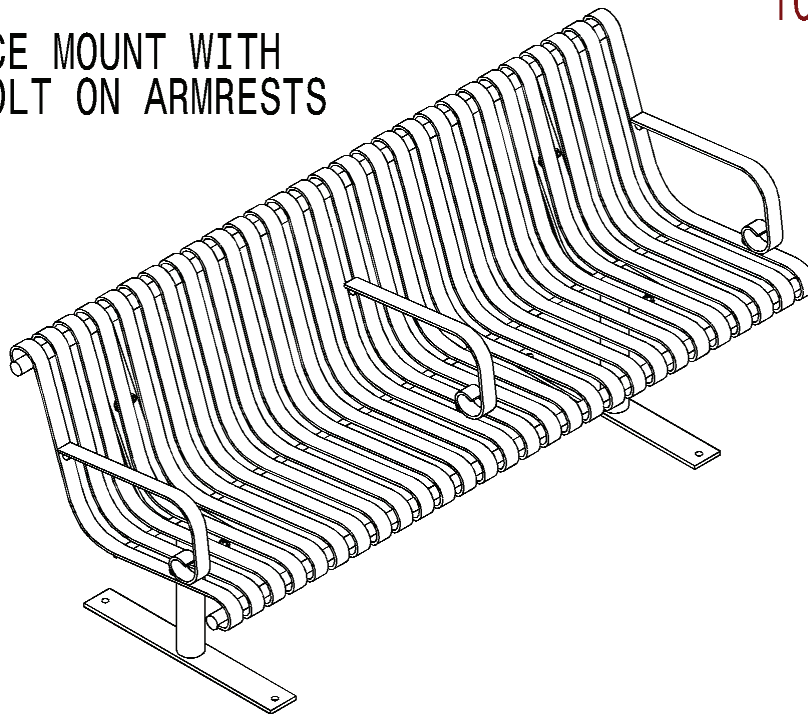

Lock washer when  
**HAND** tightened

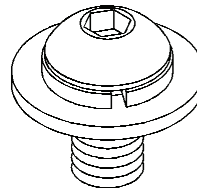

Lock washer when  
**TOOL** tightened  
**DO NOT OVER TIGHTEN**