

\* ALL DIMENSIONS ARE IN INCHES \*

1 - REMOVE ALL PARTS FROM THEIR BOXES AND BAGS. PLACE ON TOWELS OR A SOFT SURFACE TO PREVENT SCRATCHING THE FINISH.

2A - FOR WOOD SLATS: ATTACH OUTERMOST SLATS TO BENCH LEGS USING HARDWARE CONFIGURATION "A" AS SHOWN. HAND TIGHTEN ONLY. DO NOT FULLY TIGHTEN AT THIS STAGE.

HARDWARE CONFIGURATION "A"

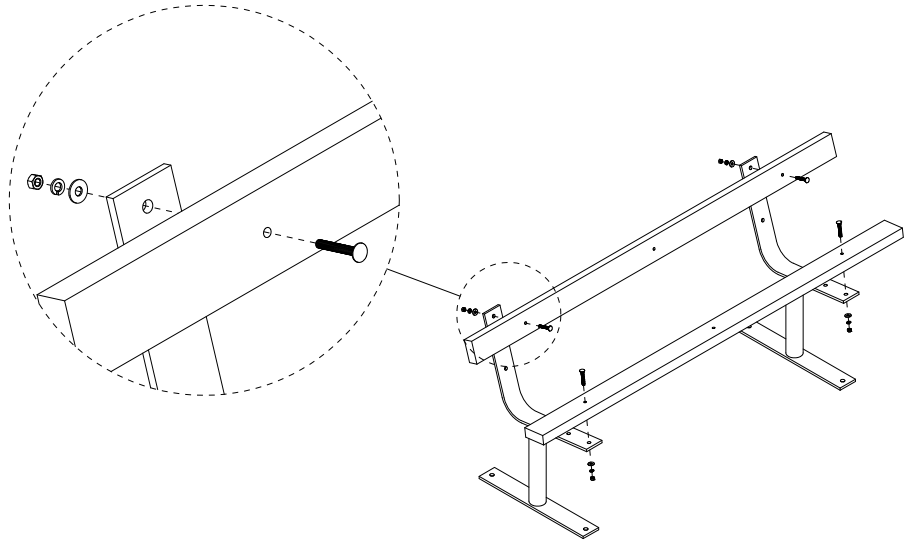
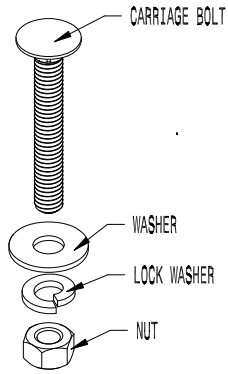

2B - FOR 2nd SITES SYSTEMS® SLATS: PLACE OUTERMOST SLATS ON BENCH LEGS WITH PILOT HOLES FACING LEG BRACES. ATTACH OUTERMOST SLATS TO BENCH LEGS FROM BELOW USING HARDWARE CONFIGURATION "B" AS SHOWN. HAND TIGHTEN ONLY. DO NOT FULLY TIGHTEN AT THIS STAGE.

HARDWARE CONFIGURATION "B"

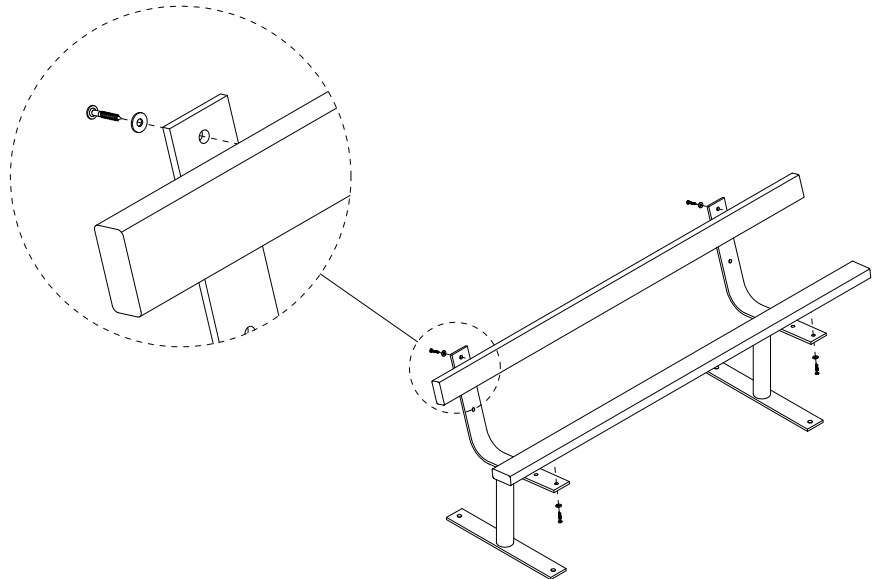
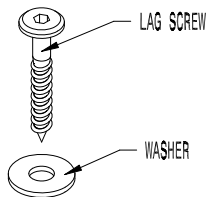

**DO NOT FULLY TIGHTEN**



RECYCLED SLAT TABLE WITH BENCHES  
 SHOWN: GENERAL ASSEMBLY INSTRUCTIONS  
 STANDARD 6-FOOT LENGTH  
 STANDARD SURFACE MOUNT

\* ALL DIMENSIONS ARE IN INCHES \*

3 - REPEAT STEP 2A OR 2B FOR REMAINING SLATS. HAND TIGHTEN ONLY. DO NOT FULLY TIGHTEN AT THIS STAGE.

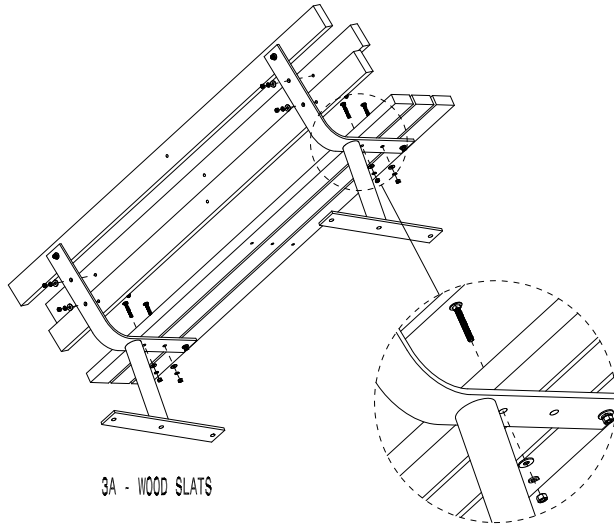

3A - WOOD SLATS

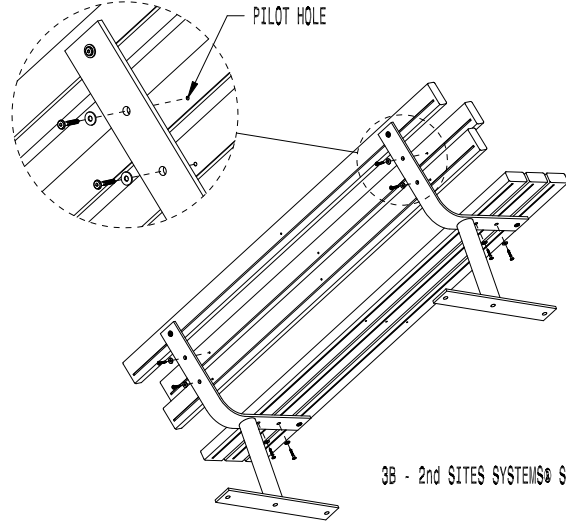

3B - 2nd SITES SYSTEMS® SLATS

4A - FOR WOOD SLATS: ATTACH CENTER BRACE USING HARDWARE CONFIGURATION "A". HAND TIGHTEN ONLY. DO NOT FULLY TIGHTEN AT THIS STAGE.

4B - FOR 2nd SITES SYSTEMS® SLATS: ATTACH CENTER BRACE USING HARDWARE CONFIGURATION "B". HAND TIGHTEN ONLY. DO NOT FULLY TIGHTEN AT THIS STAGE.

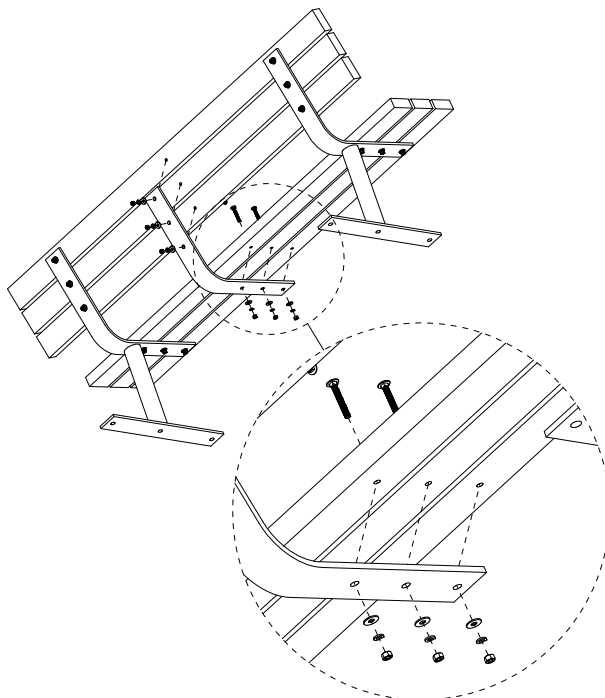

4A - WOOD SLATS

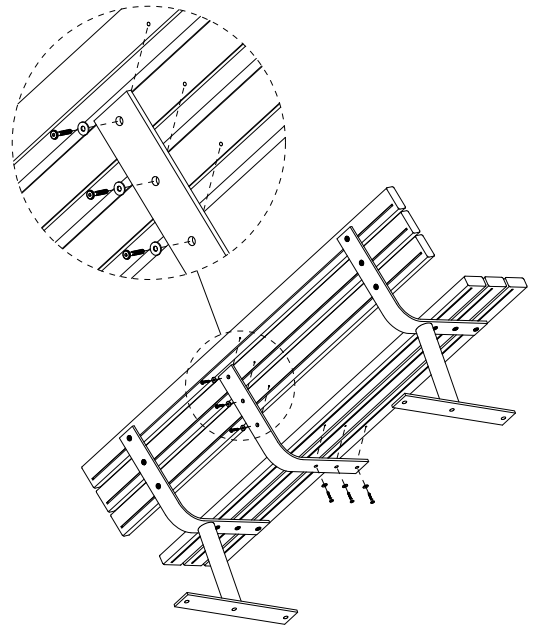

4B - 2nd SITES SYSTEMS® SLATS

**DO NOT FULLY TIGHTEN**



**MODEL 2**  
 GREENSITES

RECYCLED SLAT TABLE WITH BENCHES  
 SHOWN: GENERAL ASSEMBLY INSTRUCTIONS  
 STANDARD 6-FOOT LENGTH  
 STANDARD SURFACE MOUNT

\* ALL DIMENSIONS ARE IN INCHES \*

- 5 - ONCE ALL SLATS ARE ATTACHED, SET BENCH IN DESIRED LOCATION. TO PROTECT THE FINISH, BE SURE TO NOT DRAG BENCH FEET ON THE GROUND.
- 6 - USE LEVEL TO CHECK ALIGNMENT OF BENCH. ONCE ALL SLATS ARE PROPERLY SPACED AND ALIGNED, TOOL TIGHTEN ALL HARDWARE.
  - A - FOR WOOD SLATS: USE A 1/2" SOCKET WRENCH.
  - B - FOR 2nd SITES SYSTEM® SLATS: USE PROVIDED HEX DRIVER BIT.

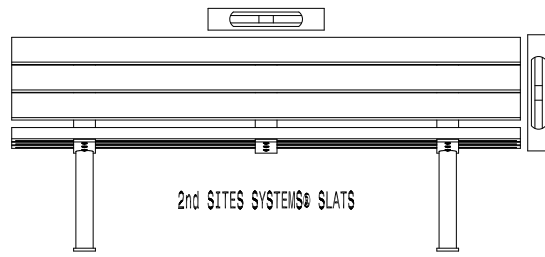
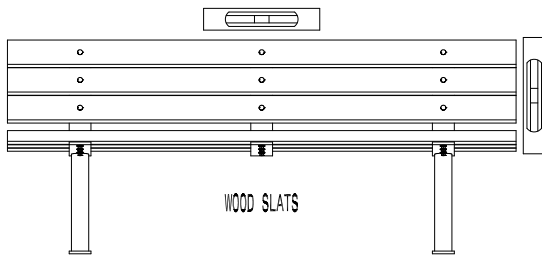

HARDWARE CONFIGURATION "A"  
FASTENER BEFORE TOOL TIGHTENING

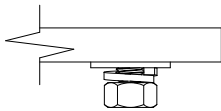

HARDWARE CONFIGURATION "A"  
FASTENER AFTER TOOL TIGHTENING

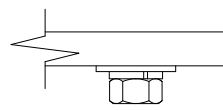

**DO NOT OVER TIGHTEN**

- 7 - THE BENCH CAN NOW BE SECURED IN PLACE. CHECK AND REVIEW LOCATION AND POSITIONING. MAKE ANY ADJUSTMENTS TO PLACEMENT/LOCATION NOW. MARK LOCATION OF ANCHOR BOLT HOLES. REMOVE BENCH AND PLACE ANCHOR BOLTS IN POSITION.

(4) ANCHOR BOLTS HOLES ARE USED ON THIS BENCH WITH CLEARANCE FOR UP TO 1/2" ANCHOR BOLTS.  
 ANCHOR BOLTS ARE NOT SUPPLIED BY VICTOR STANLEY, LLC.  
 CONSULT YOUR LOCAL CODES FOR REGULATIONS.

- 8 - ONCE ANCHOR BOLTS ARE IN PLACE, REPLACE BENCH IN POSITION AND TOOL TIGHTEN ANCHOR BOLTS.

**FINAL PRODUCT**

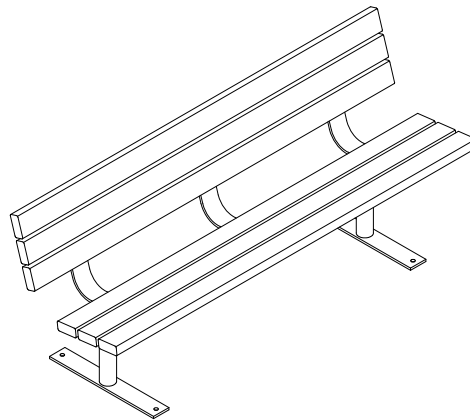
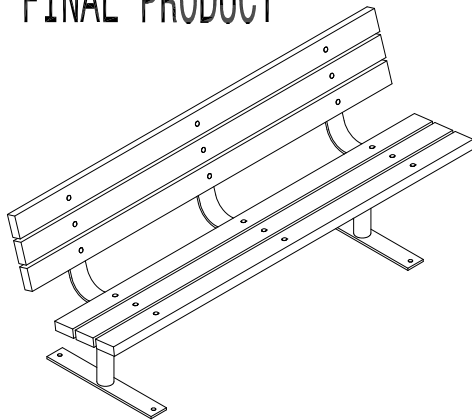

RECYCLED SLAT TABLE WITH BENCHES  
 SHOWN: GENERAL ASSEMBLY INSTRUCTIONS  
 STANDARD 6-FOOT LENGTH  
 STANDARD SURFACE MOUNT